



RoboMIG **TBi RM 50W**

Technical data

Robot welding torch TBi RM 50W

Rating at 100% duty cycle
(10 min. cycle)

- Mixed gas: 9.5 kW (approx. 270 - 300 A)

Cooling method 1-circuit water cooling

Wire diameter 0.8 - 1.2 mm

Gas consumption from 8 l/min

Gas flow 1 channel for protective and
blow-out gas

Weight approx. 0.70 kg

Technical specification according to IEC 60974-7

Connection TBi WH flange compatible to our
WH cable assemblies, PowerPull
wire feeders and quick-change
adaptor.

Torch rating will be reduced when using pulse-arc power sources.

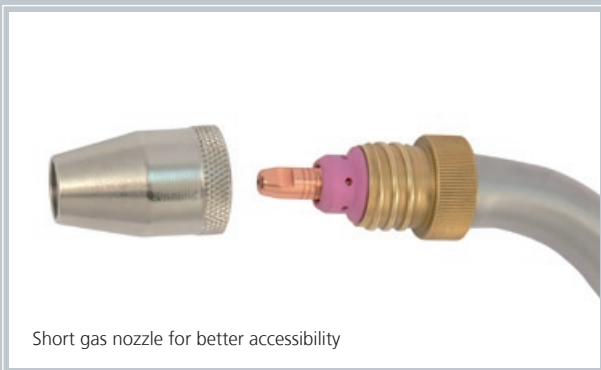

Short gas nozzle for better accessibility

Ordering information

**TBi RM 50W,
Torch neck with nozzle holder**

**for direct clamping
45°**

**for quick-change adaptor
45°**

Please order consumables separately as needed.

671P101142

671P101141

Dimensions

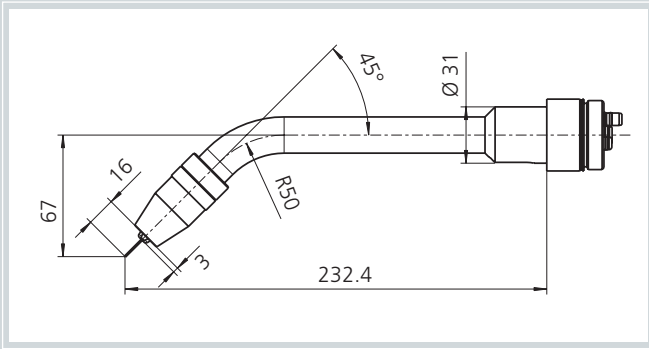

The TBI RoboMIG welding torch RM 50W has a very rugged design with a stainless steel outer tube. Therefore, the factory set TCP will neither be changed by thermal stresses during welding nor collisions.

The compact and short torch head of the TBI RoboMIG RM 50G / 50W welding torches offers an exceptionally good accessibility. The changeable nozzle holder allows the end user to easily recondition the torch even after a long time of use.

When ordering, please make sure to choose the correct type for either direct clamping or for the quick-change adaptor. The torches are adjusted differently and must be used only for the corresponding mounting option.

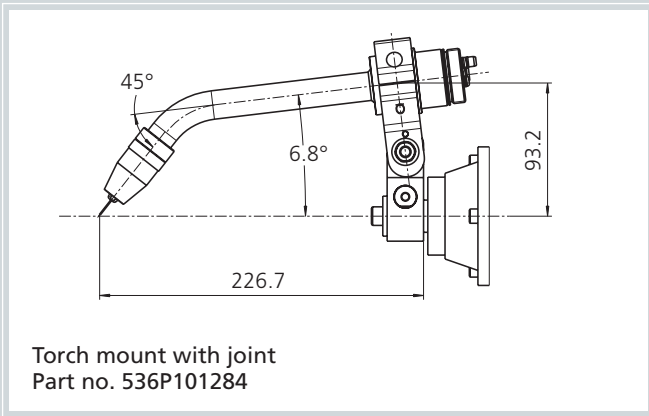

Torch mount with joint
Part no. 536P101284

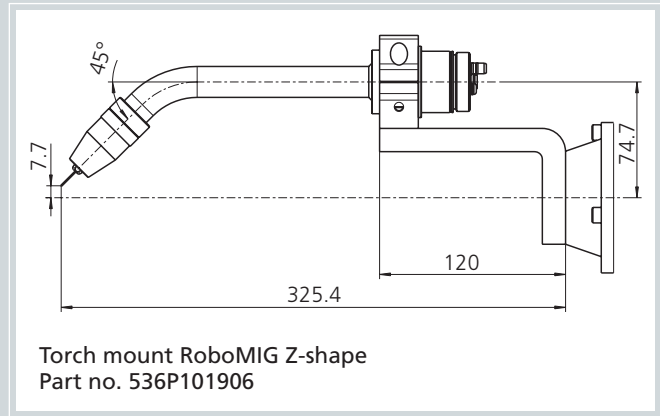

Torch mount RoboMIG Z-shape
Part no. 536P101906

Spare parts and consumables

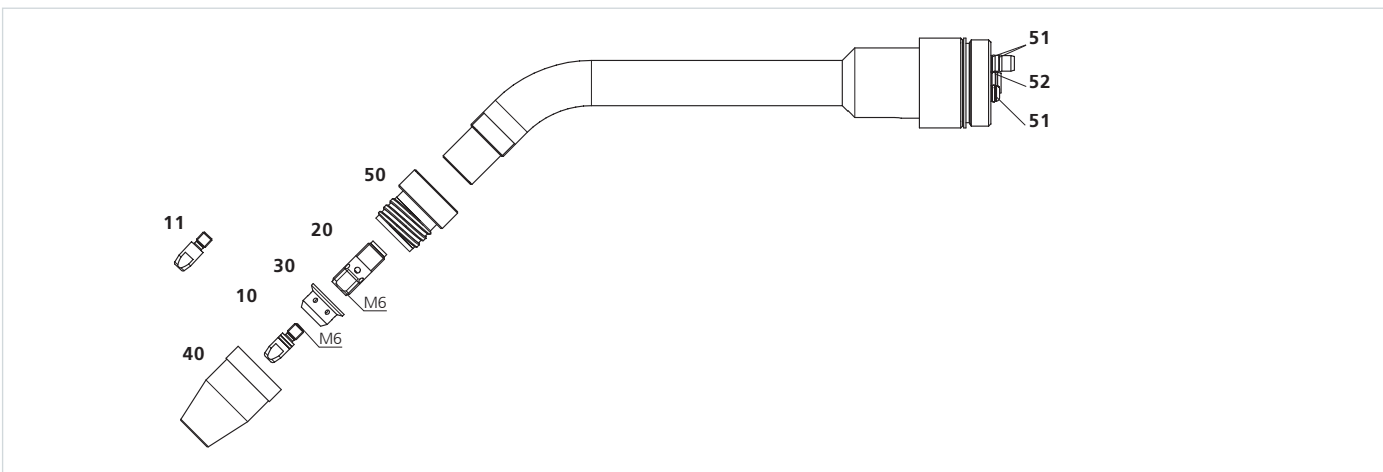

Pos.	Description	Part no.
------	-------------	----------

Contact tips

▶ 10	Contact tips M6x22, StarTip	344P_6092*
11	Contact tip M6x22, ECu	340P_1092*

Tip holder

▶ 20	Tip holder M6	671P102079
------	---------------	------------

Nozzle insulator

▶ 30	Nozzle insulator ceramic	875P102010
------	--------------------------	------------

Pos.	Description	Part no.
------	-------------	----------

Gas nozzle

▶ 40	Nozzle con. NW 14.0 mm	345P155875
------	------------------------	------------

Spare parts

50	Nozzle holder	671P102067
51	O-ring 5.0x1.2 mm	365P120050
52	O-ring 7.0x1.5 mm	365P150070

▶ = Standard equipment

* At the blank, please insert suitable information for wire diameter, e.g. 08 for 0.8 mm.

© 2010 TBI Industries GmbH. All rights reserved. Subject to change without notice. Warranty only when using original TBI consumables and spare parts. Excerpts and reprints not permitted. Nr. DOKP141022, 02/2010.



RoboMIG **TBi RM 60W**

Technical data

Robot welding torch **TBi RM 60W**

Rating at 100% duty cycle
(10 min. cycle)

- Mixed gas: 13.0 kW (approx. 350 - 370 A)

Cooling method 2-circuit water cooling

Wire diameter 0.8 - 1.6 mm

Gas consumption from 8 l/min

Gas flow 1 channel for protective and
blow-out gas

Weight approx. 0.73 kg

Technical specification according to IEC 60974-7

Connection **TBi WH** flange compatible to our
WH cable assemblies, **PowerPull**
wire feeders and quick-change
adapter.

Torch rating will be reduced when using puls-arc power sources.

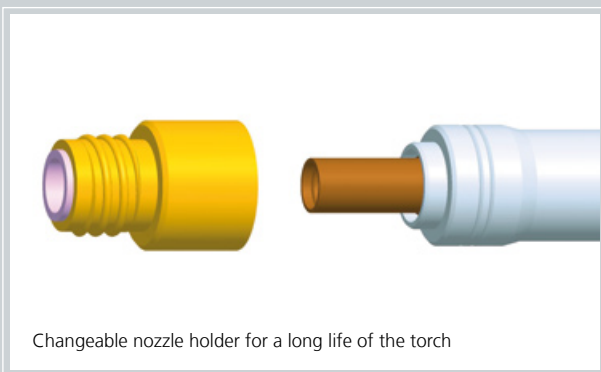

Changeable nozzle holder for a long life of the torch

Ordering information

TBi RM 60W,
Torch neck with nozzle holder

Please order consumables separately as needed.

universal 0°	for direct clamping		for quick-change adapter	
	22°	45°	22°	45°
671P101381	671P101384	671P101385	671P101382	671P101383

Dimensions

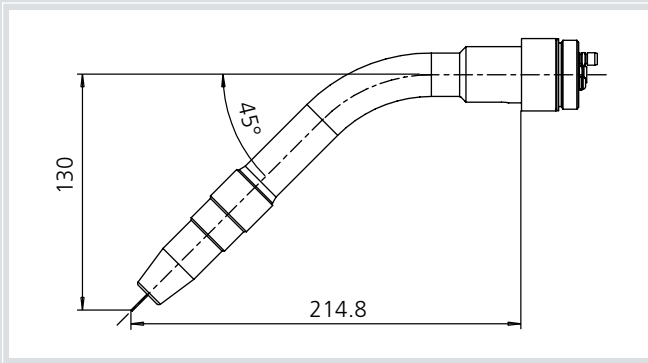
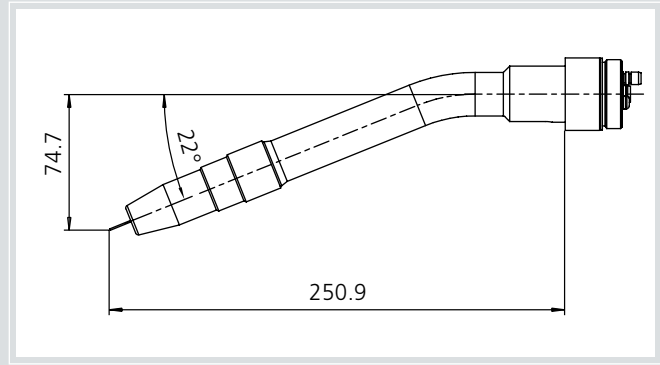
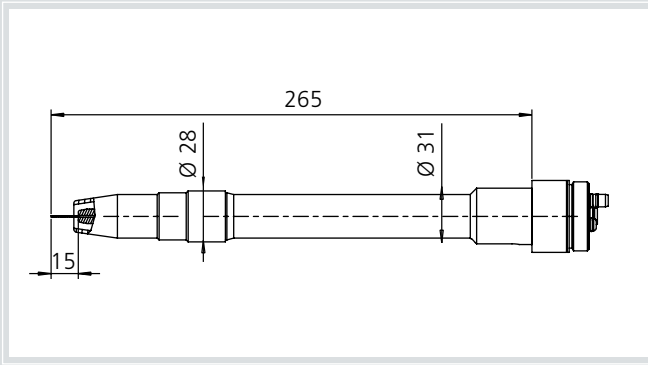

The TBI RoboMIG welding torch RM 60W has a very rugged design with a stainless steel outer tube. Therefore, the factory-set TCP will neither be changed by thermal stresses during welding nor collisions.

The changeable nozzle holder allows the end user to easily recondition the torch after a long time of use.

When ordering, please make sure to choose the correct type for either direct clamping or for the quick-change adaptor. The torches are adjusted differently and must be used only for the corresponding mounting option.

Spare parts and consumables

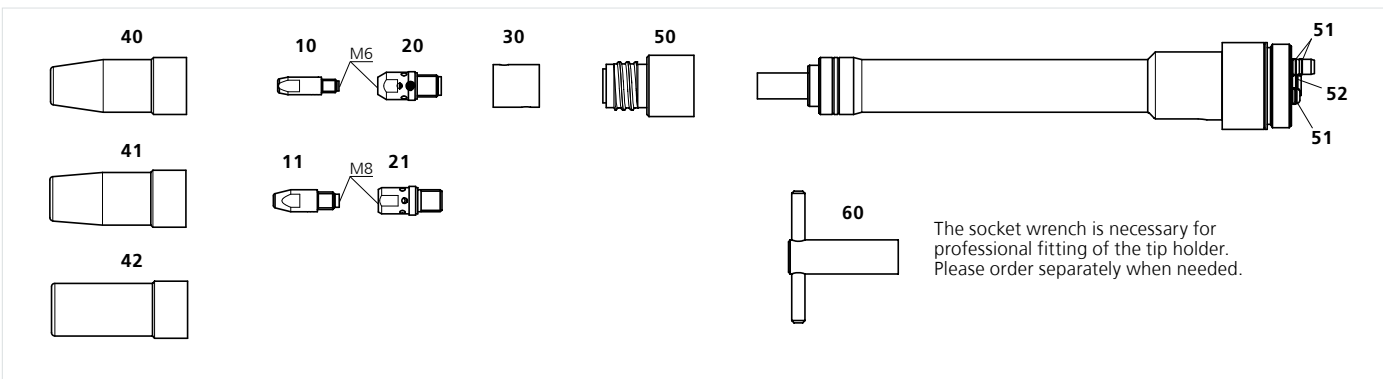

The socket wrench is necessary for professional fitting of the tip holder. Please order separately when needed.

Pos. Description Part no.

Contact tips

10	Contact tip M6x28, ECu	340P__1069*
▶ 10	Contact tip StarTip M6x28	344P__6069*
11	Contact tip M8x30, ECu	340P__1262*
11	Contact tip StarTip M8x30	344P__6262*

Tip holders

▶ 20	Tip holder M6, forced contact	671P102056
21	Tip holder M8, forced contact	671P102062

Nozzle insulator

▶ 30	Nozzle insulator ceramic	346P014661
------	--------------------------	------------

▶ = Standard equipment

* At the blank, please insert suitable information for wire diameter, e.g. 08 for 0.8 mm.

Pos. Description Part no.

Gas nozzles

▶ 40	Nozzle con. NW 13.0 mm, for M6	345P123671
41	Nozzle con. NW 16.0 mm, for M8 (M6)	345P122671
42	Nozzle cyl. NW 19.8 mm	345P121671

Spare parts

50	Nozzle holder RM 60W	671P101040
51	O-ring 5.0x1.2 mm	365P120050
52	O-ring 7.0x1.5 mm	365P150070

Accessories

60	Socket wrench	391P101006
----	---------------	------------



RoboMIG **TBi RM 80W**

Technical data

Robot welding torch TBi RM 80W

Rating at 100% duty cycle
(10 min. cycle)

- Mixed gas: 17.5 kW (approx. 370 - 500 A)

Cooling method 2-circuit water cooling

Wire diameter 0.8 - 1.6 mm

Gas consumption from 6 l/min

Gas flow 2 channels for protective and blow-out gas

Weight approx. 0.70 kg

Technical specification according to IEC 60974-7

Connection TBi WH flange compatible to our WH cable assemblies, PowerPull wire feeders and quick-change adapter.

Torch rating will be reduced when using puls-arc power sources.



Ordering information

**TBi RM 80W,
Torch neck without consumables**

Please order consumables separately when needed.

**universal
0°**

671P101187

**for direct clamping
22° 45°**

671P101188

671P101186

**for quick-change adapter
22° 45°**

671P101189

671P101175



Dimensions

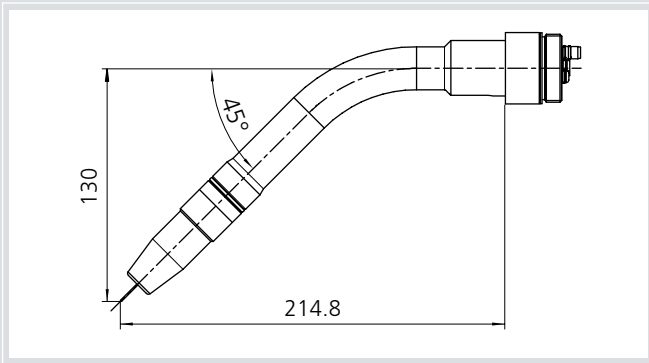
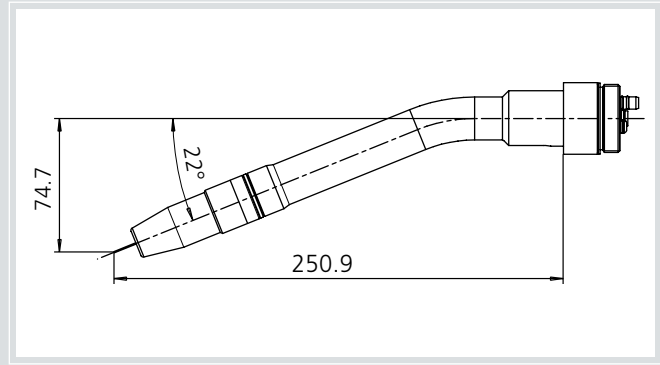
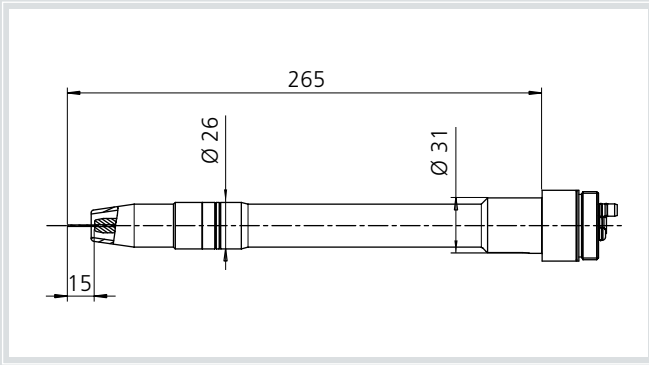

The TBI RoboMIG welding torch RM 80W has a very rugged design with a stainless steel outer tube. Therefore, the factory-set TCP will neither be changed by thermal stresses during welding nor collisions. This fact greatly simplifies maintenance of the welding cell.

The RM 80W has a fixed gas nozzle holder which guarantees a very efficient cooling of the gas nozzle.

When ordering, please make sure to choose the correct type for either direct clamping or for the quick-change adaptor. The torches are adjusted differently and must be used only for the corresponding mounting option.

Spare parts and consumables

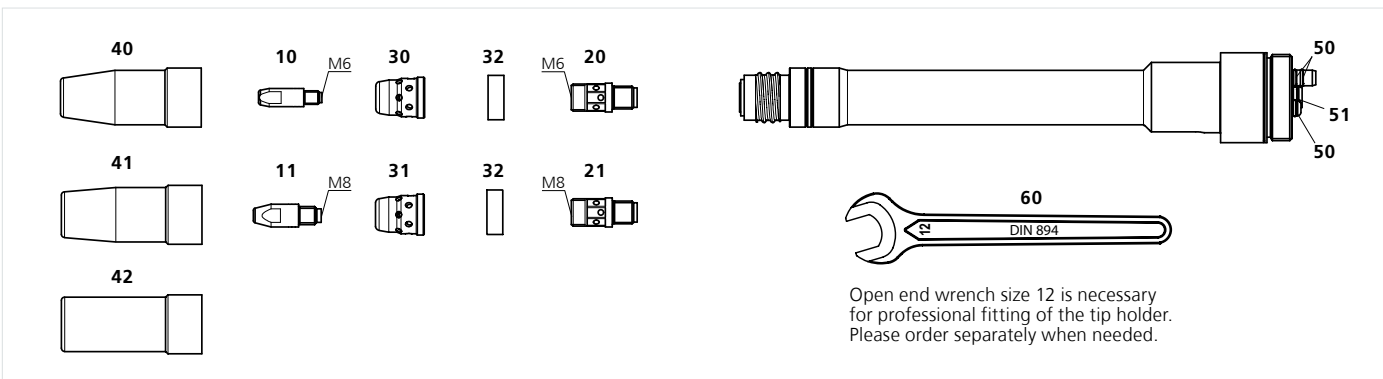

Open end wrench size 12 is necessary for professional fitting of the tip holder. Please order separately when needed.

Pos.	Description	Part no.
Contact tips		
10	Contact tip M6x28, ECu	340P__1069*
10	Contact tip StarTip M6x28	344P__6069*
11	Contact tip M8x30, ECu	340P__1262*
▶ 11	Contact tip StarTip M8x30	344P__6262*
Tip holders		
20	Tip holder M6, forced contact	671P102064
▶ 21	Tip holder M8, forced contact	671P102065

Pos.	Description	Part no.
Gas diffusers / Nozzle insulator		
30	Gas diffusor, ceramic, for M6	671P102003
▶ 31	Gas diffusor, ceramic, for M8	671P102038
▶ 32	Nozzle insulator, PTFE	346P012671
Gas nozzles		
40	Nozzle con. NW 13.0 mm, for M6	345P123671
▶ 41	Nozzle con. NW 16.0 mm, for M8 (M6)	345P122671
42	Nozzle cyl. NW 19.8 mm	345P121671
Spare parts		
50	O-ring 5.0x1.2 mm	365P120050
51	O-ring 7.0x1.5 mm	365P150070

Accessories

60	Open end wrench for tip holder, size 12 mm	391P102025
----	--	------------

▶ = Standard equipment

* At the blank, please insert suitable information for wire diameter, e.g. 08 for 0.8 mm.

© 2008 TBI Industries GmbH. Alle rights reserved. Subject to change without notice. Excerpts and reprints not permitted. Nr. DOKP141062, 02/2008.



RoboMIG TBi RM 90W

Technical data

Robot welding torch TBi RM 90W

Rating at 100% duty cycle
(10 min. cycle)

- Mixed gas: 19.0 kW (approx. 500 - 550 A)

Cooling method 2-circuit water cooling

Wire diameter 0.8 - 1.6 mm

Gas consumption from 8 l/min

Gas flow 1 channel for protective and
blow-out gas

Weight approx. 0.70 kg

Technical specification according to IEC 60974-7

Connection TBi WH flange compatible to our
WH cable assemblies, PowerPull
wire feeders and quick-change
adaptor.

Torch rating will be reduced when using pulse-arc power sources.



Ordering information

**TBi RM 90W,
Torch neck without consumables**
Please order consumables separately as needed.

universal 0°	for direct clamping		for quick-change adaptor	
	22°	45°	22°	45°
671P101231	671P101234	671P101235	671P101232	671P101233

Dimensions

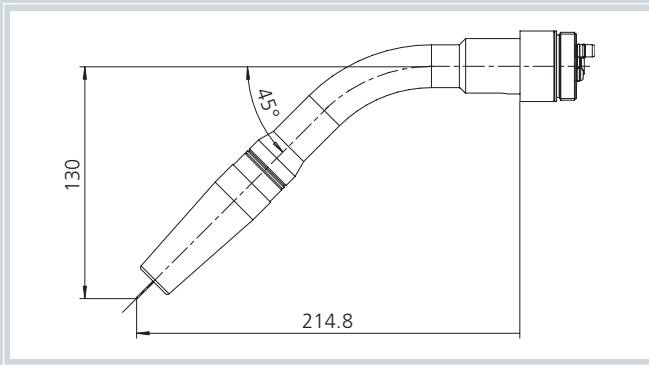
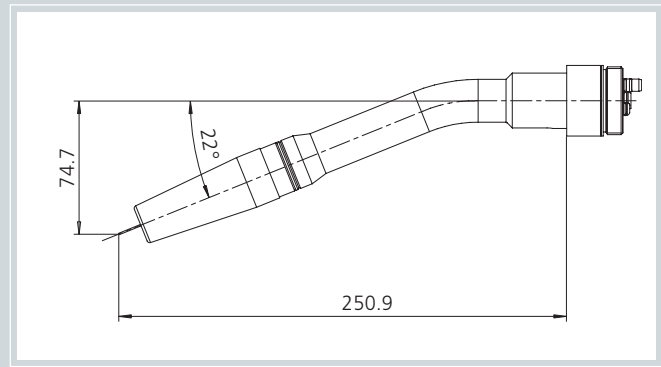
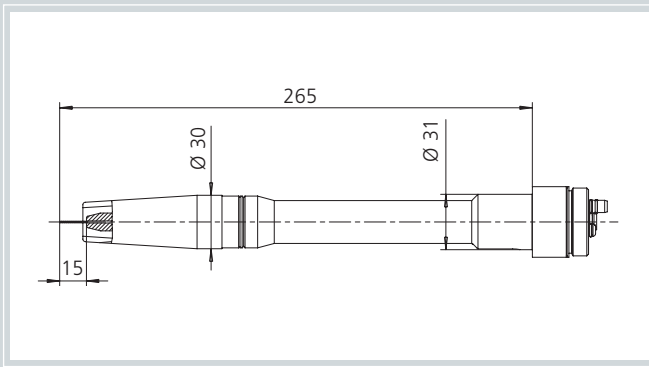

The TBI RoboMIG welding torch RM 90W has a very rugged design with a stainless steel outer tube. Therefore, the factory set TCP will neither be changed by thermal stresses during welding nor collisions. This fact greatly simplifies maintenance of the welding cell.

Due to large cross sections, this torch features specially good cooling properties.

When ordering, please make sure to choose the correct type for either direct clamping or for the chick-change adaptor. The torches are adjusted differently and must be used only for the corresponding mounting option.

Spare parts and consumables

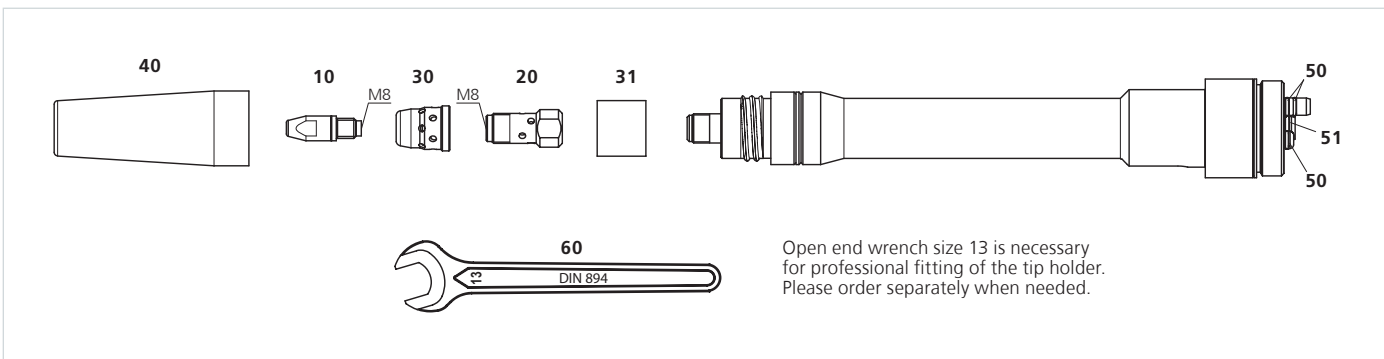

Open end wrench size 13 is necessary for professional fitting of the tip holder. Please order separately when needed.

Pos.	Description	Part no.
Contact tips		
10	Contact tip M8x30, ECu	340P_1262*
▶ 10	Contact tip StarTip M8x30	344P_6262*
Tip holder		
▶ 20	Tip holder M8, forced contact	661P102014
Gas diffuser / nozzle insulator		
▶ 30	Gas diffuser ceramic	671P102038
▶ 31	Nozzle insulator	346P019671

Pos.	Description	Part no.
Gas nozzle		
▶ 40	Nozzle con. NW 16.0 mm	345P023661
Spare parts		
50	O-ring 5.0x1.2 mm	365P120050
51	O-ring 7.0x1.5 mm	365P150070
Accessories		
60	Open end wrench, size 13 mm	391P102026

▶ = Standard equipment

* At the blank, please insert suitable information for wire diameter, e.g. 08 for 0.8 mm.

© 2008 TBI Industries GmbH. All rights reserved. Subject to change without notice. Warranty only when using original TBI consumables and spare parts. Excerpts and reprints not permitted. Nr. DOKP141072, 09/2008.